

# The Seville Rows at Villebois

Costa Pacific Homes

Wilsonville, Oregon

2,012 - 2,270 sq. ft. plans

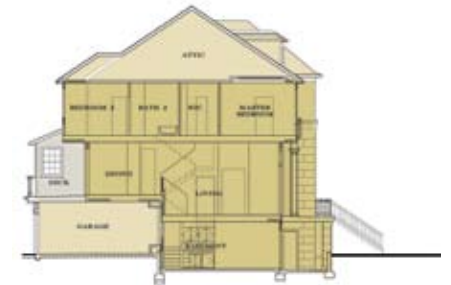

The Seville Rows are located near the Village Center in a transit-connected community south of Portland. The two and a half story homes are designed in graceful European style architecture. They have entrances a half-level above the street to provide privacy for the living areas, and the interior areas encompass the spacious feel of a single family home. The two floor plans include 2 bedrooms, 2 ½ baths with optional loft/bedroom and basement/junior suite options, all with direct two-car garage access. The front porches, patios, and numerous covered decks enhance the opportunities for an outdoor oriented lifestyle.